

1. For the **F3D-2Q / EF-10B** versions, glue part **ö** on the panel. The map desk **ä** is optional.

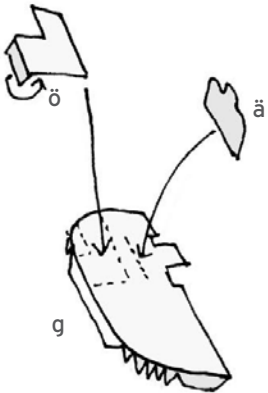

2. For the **all other versions**, roll and glue part **β** then install it on the panel. The map desk **ä** is optional.



## F3D cockpit instructions

5. Build the cockpit tub, glue on the rear armature and the escape door

3. Build the pilot seat

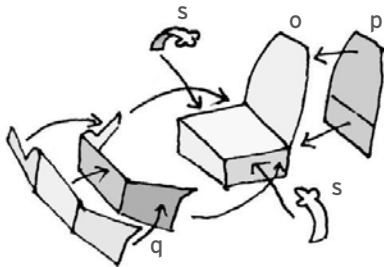

4. Build the systems operator seat

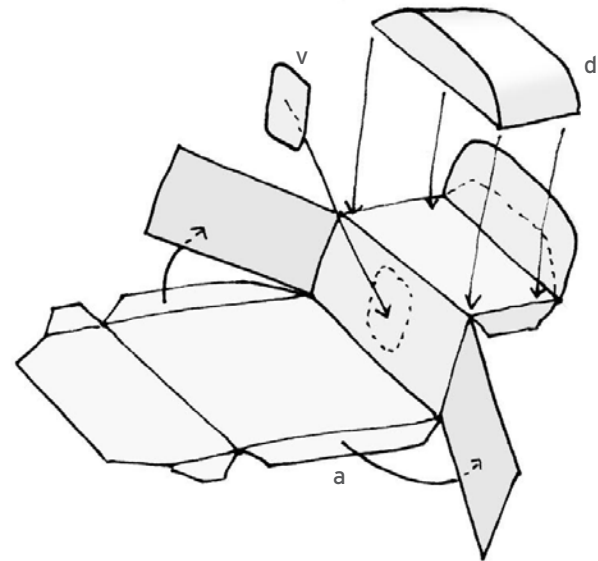
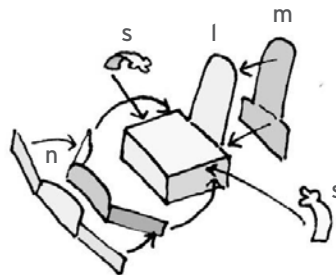

6. Install the side panels and the center panel

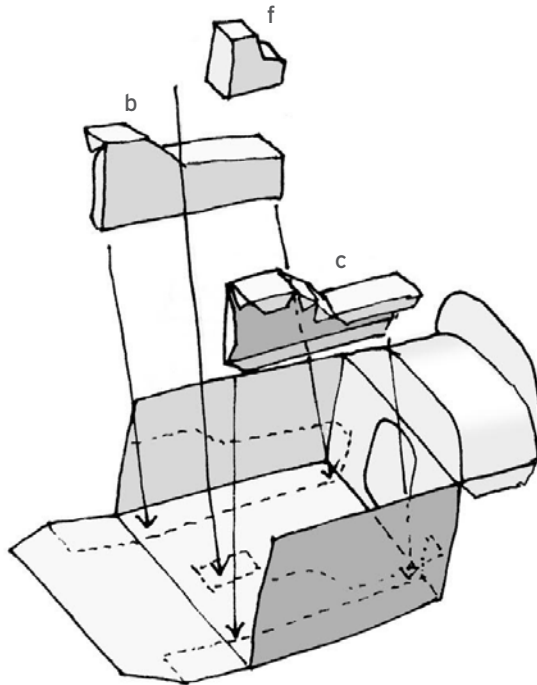

7. install main panel, seats, control stick, footrest and pedals.

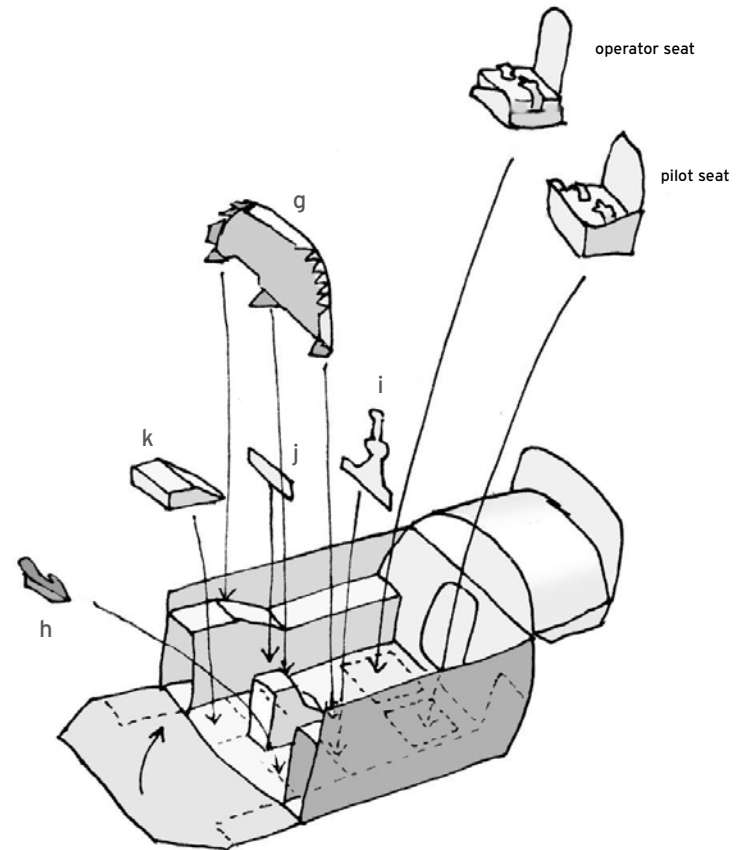

8. Install overhead girders, headrests and main seat belts

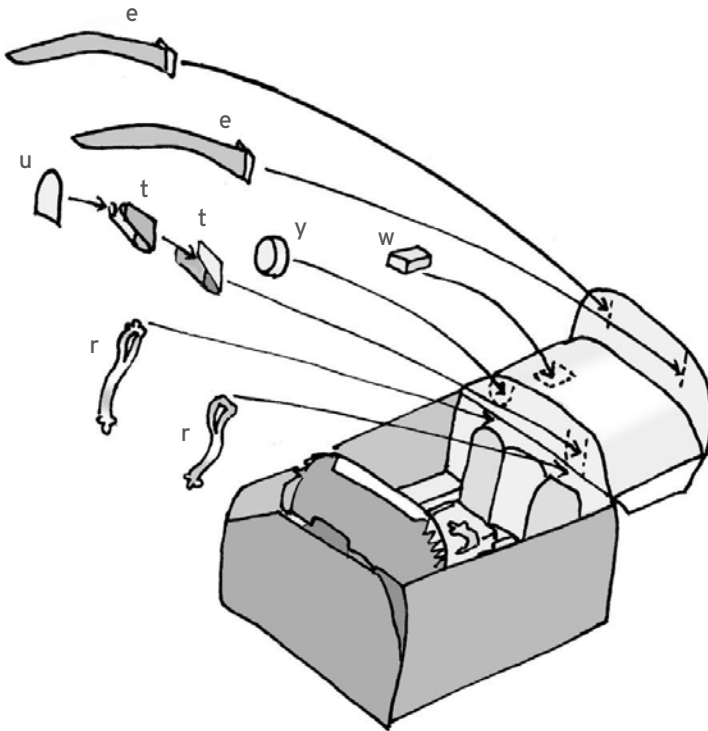

9. Install the cockpit into the forward fuselage

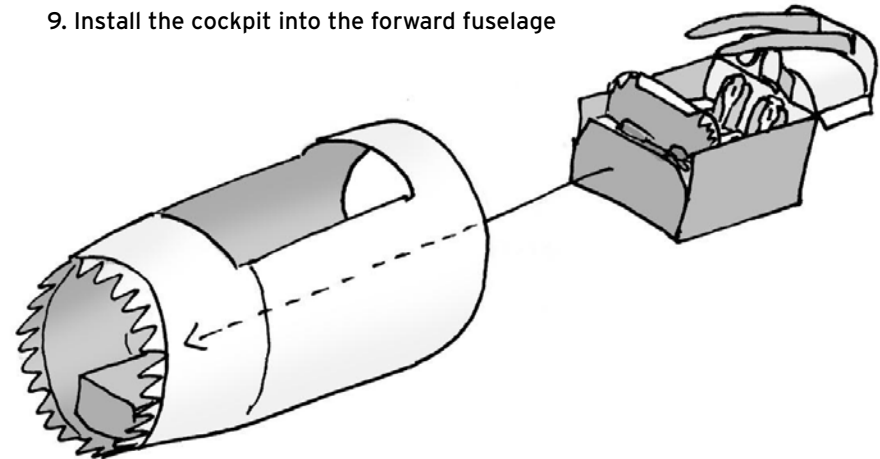

10. Install the forward fitting and the crosshair

